



COUNCIL OF THE CITY OF NEW YORK

**CALENDAR
OF THE**

LAND USE COMMITTEE

FOR THE WEEK OF OCTOBER 17, 2016 - OCTOBER 21, 2016

DAVID G. GREENFIELD, *Chair*, Land Use Committee

DONOVAN J. RICHARDS, *Chair*, Subcommittee on Zoning and Franchises

PETER KOO, *Chair*, Subcommittee on Landmarks, Public Siting
and Maritime Uses

INEZ DICKENS, *Chair*, Subcommittee on Planning, Dispositions
and Concessions

<http://legistar.council.nyc.gov/Calendar.aspx>

SUBCOMMITTEE ON ZONING AND FRANCHISES

The Subcommittee on Zoning and Franchises will hold a public hearing on the following matters in the **Council Committee Room, 250 Broadway, 16th Floor**, New York City, New York 10007, commencing at **9:30 A.M., Wednesday, October 19, 2016:**

L.U. No. 470

REEF

QUEENS - CB 6

20175051 TCQ

Application pursuant to Section 20-226 of the Administrative Code of the City of New York, concerning the petition of 10802 72nd Rest, LLC, d/b/a Reef, for a new revocable consent to establish, maintain and operate an unenclosed sidewalk café located at 108-02 72nd Avenue.

L.U. No. 471

HAPPY COOKING BISTRO

MANHATTAN - CB 2

20165243 TCM

Application pursuant to Section 20-225 of the Administrative Code of the City of New York, concerning the petition of Happy Cooking Bistro, LLC, d/b/a Happy Cooking Bistro, for a new revocable consent to establish, maintain and operate an enclosed sidewalk café located at 322 Spring Street.

L.U. NOS. 472, 473, AND 474 ARE RELATED

L.U. No. 472

141 WILLOUGHBY STREET REZONING

BROOKLYN - CB 2

C 160030 ZMK

Application submitted by 385 Gold Property Investors IIA, LLC pursuant to Sections 197-c and 201 of the New York City Charter for an amendment of the Zoning Map, Section No. 16c:

1. changing from a C6-1 District to a C6-6 District property bounded by Willoughby Street, Gold Street, a line 200 feet northerly of Willoughby Street, and Flatbush Avenue Extension; and
2. changing from a C6-4 District to a C6-6 District property bounded by Gold Street and its northerly centerline prolongation, a line 320 feet northerly of Willoughby Street, Flatbush Avenue Extension, and a line 200 feet northerly of Willoughby Street.

L.U. No. 473

141 WILLOUGHBY STREET REZONING

BROOKLYN - CB 2

C 160054 MMK

Application submitted by The New York City Department of Housing Preservation and Development and The New York City Economic Development Corporation, LLC pursuant to Sections 197-c and 199 of the New York City Charter, and Section 5-430 *et seq.* of the New York City Administrative Code for an amendment to the City Map involving:

- the elimination, discontinuance and closing of a portion of Flatbush Avenue Extension at its intersection with Gold Street; and
- the adjustment of grades and block dimensions necessitated thereby;

including authorization for any acquisition or disposition of real property related thereto, in accordance with Map Nos. X-2745 and X-2746 dated April 1, 2016 and signed by the Borough President.

L.U. No. 474

141 WILLOUGHBY STREET REZONING

BROOKLYN - CB 2

N 160029 ZRK

Application for an amendment to the Zoning Resolution submitted by 385 Gold Property Investors IIA, LLC, modifying X, Chapter 1 (Special Downtown Brooklyn District) to add a C6-6 District and update its bulk and envelope regulations, and modifying Appendix F (Inclusionary Housing Designated Areas) to add a Mandatory Inclusionary Housing Area to the proposed project area in the Borough of Brooklyn, Community District 2.

Matter in underline is new, to be added;

Matter in ~~strikeout~~ is to be deleted;

Matter within # # is defined in Section 12-10;

* * * indicates where unchanged text appears in the Zoning Resolution

ARTICLE X:

SPECIAL PURPOSE DISTRICTS

Chapter 1

Special Downtown Brooklyn District

* * *

101-20

SPECIAL BULK REGULATIONS

101-21

Special Floor Area and Lot Coverage Regulations

R7-1 C6-1 C6-4.5 C6-6

* * *

(d) In C6-6 Districts

In C6-6 Districts, the maximum permitted #floor area ratio# for #commercial# or #community facility uses# shall be 18.0.

* * *

101-222

Standard height and setback regulations

C2-4/R7-1 C6-1 C6-4.5 C6-6

In the districts indicated, except C6-1A Districts, a #building or other structure# shall not exceed the applicable maximum #building# height set forth in the table in this Section. Furthermore, any portion of a #building or other structure# that exceeds the applicable maximum base height shall be set back at least 10 feet from a #wide street line# and at least 15 feet from a #narrow street line#.

**MAXIMUM BASE HEIGHTS AND MAXIMUM BUILDING HEIGHTS
IN C2-4/R7-1, C6-1, ~~AND~~ C6-4.5 AND C6-6 DISTRICTS**

District	Maximum Base Height		Maximum #Building# Height	
	Beyond 100 feet of a #wide street#	Within 100 feet of a #wide street#	Beyond 100 feet of a #wide street#	Within 100 feet of a #wide street#
* * *	* * *	* * *	* * *	* * *
C6-4.5 <u>C6-6</u>	125	150	250	250

101-223

Tower regulations

C5-4 C6-1 C6-4 C6-6

In the districts indicated, except C6-1A Districts, the provisions of this Section shall apply as an alternative to the provision of Section 101-222 (Standard height and setback regulations).

* * *

(b) Setback requirements for #commercial# or #community facility# towers

For #buildings# that contain #commercial# or #community facility floor area# above a height of 85 feet, a setback is required for all portions of such #buildings# that exceed a height of 85 feet.

For #zoning lots# that do not exceed a #lot area# of 15,000 square feet, such portions of buildings# shall be set back at least 10 feet from a #wide street line# and at least 15 feet from a #narrow street line#. For #zoning lots# that exceed an area of 15,000 square feet, such portions shall be set back at least 20 feet from any #street line#.

However, setbacks shall not be required for any portion of a #building# fronting upon the south side of Willoughby Street between Gold Street and the Flatbush Avenue Extension, or upon that portion of the Flatbush Avenue Extension between Willoughby Street and DeKalb Avenue within 250 feet of Willoughby Street, or for any #building# fronting upon the north side of Willoughby Street between Gold Street and the Flatbush Avenue Extension, provided that this exemption shall not be applicable to portions of #buildings# above 85 feet that contain #residential floor area#.

* * *

(d) Maximum #building# height

In C6-1 Districts, the maximum height of a #building or other structure# shall be 495 feet. No height limit shall apply within a C5-4, ~~or~~ C6-4 or C6-6 District.

* * *

101-40

MANDATORY DISTRICT PLAN ELEMENTS

101-41

Special Street Wall Location Regulations

Map 4 (Street Wall Continuity and Mandatory Sidewalk Widening) in Appendix E of this Chapter specifies locations where the special #street wall# location regulations of

this Section apply. However, such regulations shall not apply along the #street# frontage of that portion of any #zoning lot# occupied by existing #buildings# to remain.

* * *

(d) All other areas

On all other #streets# shown on Map 4, at least 70 percent of the #aggregate width of street walls# of any #building# shall be located within eight feet of the #street line# and extend to at least a height of 40 feet in R7-1 Districts mapped within C2-4 Districts and at least a height of 60 feet in all other districts, or the height of the #building#, whichever is less, except that on #corner lots#, no #street wall# shall be required within 100 feet of the intersection of two #street lines# where the interior angle formed by such intersecting #street lines# is 45 degrees or less. However, such regulations shall not apply to any #building# fronting upon the north side of Willoughby Street between Gold Street and the Flatbush Avenue Extension.

* * *

APPENDIX F

Inclusionary Housing Designated Areas and Mandatory Inclusionary Housing Areas

* * *

BROOKLYN

* * *

Brooklyn Community District 2

* * *

In the R10 District within the area shown on the following Map 5:

Map 5 - (date of adoption)

[PROPOSED MAP]

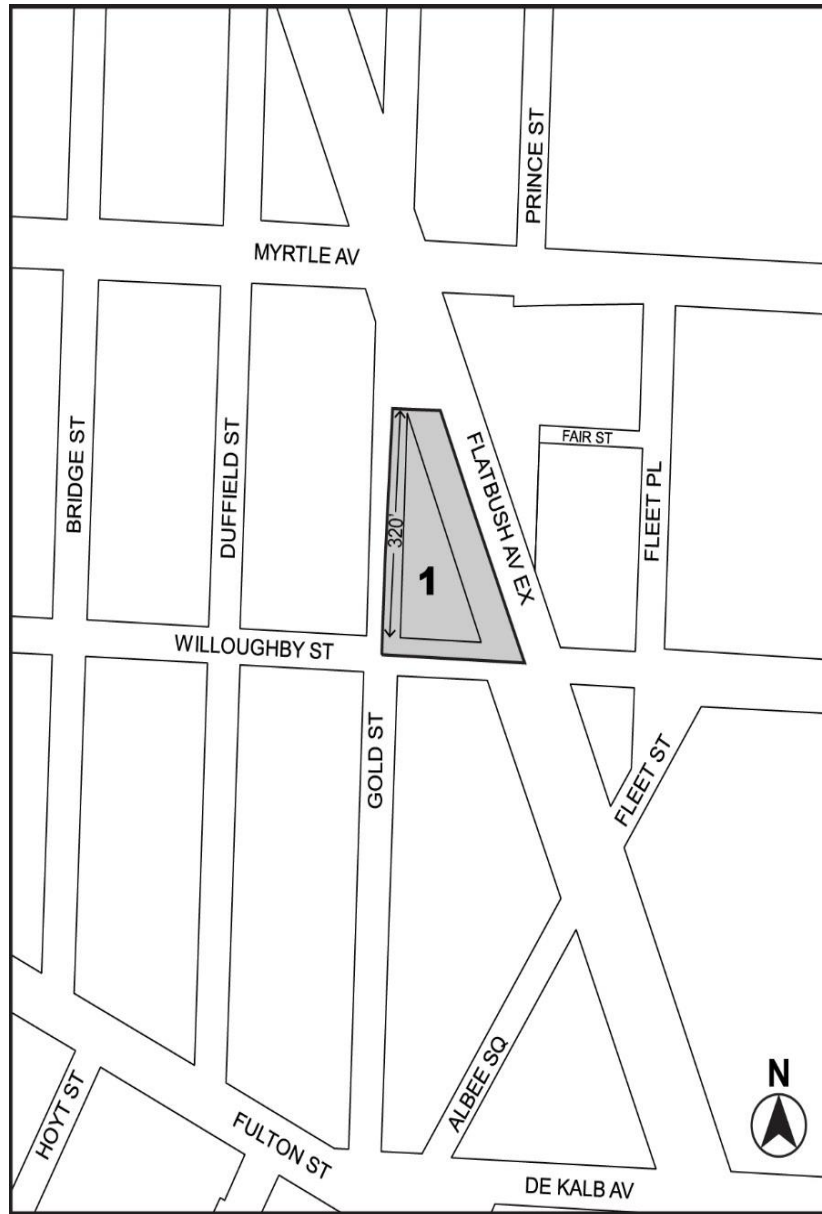

■ Mandatory Inclusionary Housing Area (MIHA) see Section 23-154(d) (3)

Area 1 (date of adoption) - MIH Program Option 2

Portion of Community District 2, Brooklyn



L.U. NOS. 482, 483, 484, 485, 486, 487 AND 488 ARE RELATED

L.U. No. 482

LAMBERT HOUSES REDEVELOPMENT

BRONX - CB 6

C 160285 ZMX

Application submitted by the New York City Department of Housing Preservation and Development and Phipps Houses pursuant to Sections 197-c and 201 of the New York City Charter for the amendment of the Zoning Map, Section No. 3d:

1. changing from an R7-1 District to an R8 District property bounded by:
 - a. a line 230 feet southeasterly of Vyse Avenue, East 180th Street, a line perpendicular to the northeasterly street line of East 180th Street distant 335 feet northwesterly (as measured along the streetline) from the point of intersection of the northeasterly street line of East 180th Street and the northwesterly street line of Boston Road, a line 100 feet northeasterly of East 180th Street, 100 feet northwesterly of Boston Road, Bronx Park South, Boston Road, East 180th Street, a line 280 feet southeasterly of Boston Road, 100 feet southwesterly of East 180th Street, 100 feet southeasterly of Boston Road, a line 140 feet northeasterly of East 179th Street, Boston Road, East 179th Street, 100 feet northwesterly of Boston Road, and 120 feet southwesterly of East 180th Street; and
 - b. Boston Road, East 179th Street, the easterly street line of former Bronx Street, East Tremont Avenue, and West Farms Road; and
2. establishing within a proposed R8 District a C1-4 District bounded by a line 100 feet northwesterly of Boston Road, Bronx Park South, Boston Road, and East 179th Street.

L.U. No. 483

LAMBERT HOUSES REDEVELOPMENT

BRONX - CB 6

C 160286 HAX

Application submitted by the New York City Department of Housing Preservation and Development (HPD) and Phipps Houses.

- 1) Pursuant to Article 16 of the General Municipal Law of New York State for:
 - a) The designation of property located at Boston Road (Block 3139, Lot 50), as an Urban Development Action Area; and
 - b) an Urban Development Action Area Project for such area; and
- 2) pursuant to Section 197-c of the New York City Charter for the disposition of such property to a developer to be selected by HPD;

to facilitate a mixed use development containing approximately 1,665 affordable residential units, approximately 86,608 square feet of retail space and approximately 110 accessory parking spaces in Community District 6.

L.U. No. 484

LAMBERT HOUSES REDEVELOPMENT

BRONX - CB 6

N 160288 ZRX

Application submitted by the Department of Housing Preservation and Development and Phipps Houses, pursuant to Section 201 of the New York City Charter, for an amendment of the Zoning Resolution of the City of New York, modifying Article VII, Chapter 8 relating to provisions for Location of Buildings, Distribution of Bulk and Open Space and Modification of Height and Setbacks in Community District 6.

Matter underlined is new, to be added;

Matter in ~~strikeout~~ is to be deleted;

Matter within # # is defined in Section 12-10;

* * * indicates where unchanged text appears in the Zoning Resolution

* * *

Article VII: ADMINISTRATION

Chapter 8 – Special Regulations Applying to Large-Scale Residential Developments

* * *

78-30

BULK REGULATIONS

78-31

Location of Buildings, Distribution of Bulk and Open Space and Modification of Height and Setbacks

(a) General provisions

For the purposes of this Section, the term "periphery" shall mean any #street line# bounding a #large-scale residential development# or any #lot line# abutting a #zoning lot# that is not part of the #large-scale residential development#. The term "wholly within" shall therefore mean any area of the #large-scale residential development# which is not within the area designated as "periphery." However, in R3-2 Districts, R4 Districts except R4A, R4-1 and R4B Districts, or R5 Districts except R5B Districts, the "periphery" shall also include all portions of a #large-scale residential development# within 100 feet of a peripheral #street line# or within 30 feet of any other peripheral #lot line#, except for portions directly opposite:

- (1) an area of at least 1.5 acres in a #Residence District# that is either vacant or #land with minor improvements#; or
- (2) a #large-scale residential development developed# pursuant to the provisions of paragraph (b) of this Section; or
- (3) a #Commercial# or a #Manufacturing District#.

All #buildings or other structures# in the periphery of a #large-scale residential development# shall comply with the height and setback regulations of Article II, Chapter 3, except as otherwise provided in this Section.

Special provisions applying to #large-scale residential developments# in R3, R4 or R5 Districts are set forth in paragraphs (b) and (c) of this Section. The provisions of paragraph (b) shall apply to any #large-scale residential development# in R3-2 Districts, R4 Districts except R4A, R4-1 and R4B Districts, or R5 Districts except R5B Districts. The provisions of paragraph (c) shall apply only to #large-scale residential developments# in all R3, R4 or R5 Districts that utilize the bonus provisions of Section 78-32 through 78-35, inclusive.

(b) Alternate height and setback regulations for certain districts

In R3-2 Districts, R4 Districts except R4A, R4-1 and R4B Districts, or R5 Districts except R5B Districts, #buildings or other structures#, or portions thereof, “wholly within” a #large-scale residential development# may use the alternate height and setback regulations set forth in paragraphs (b)(1) through (b)(3) of this Section.

- (1) In R3-2 Districts, the height and setback regulations applicable to R4 Districts, except R4A and R4B Districts, may be used.
- (2) In R4 Districts, no portion of any #building or other structure#, including the apex of a roof, shall penetrate a plane 35 feet in height above the #base plane#.
- (3) In R5 Districts, no portion of any #building or other structure#, including the apex of a pitched roof, shall penetrate a plane 40 feet in height above the #base plane#.

(c) Alternate #floor area# and #open space# regulations in R3, R4 or R5 Districts

In #large-scale residential developments# that utilize the bonus provisions of this Chapter, the #floor area ratio# and the #open space ratio# controls set forth in the

following table shall apply in lieu of the #floor area ratio# and #lot coverage# controls of Article II, Chapter 3.

District	#Open Space Ratio#	#Floor Area Ratio#
R3	150	.50*
R4	80	.75*
R5	40	1.25

* The #floor area ratio# in the table may be increased by up to 20 percent provided that any such increase in #floor area# is located under a sloping roof which rises at least 3 1/2 inches in vertical distance per each foot of horizontal distance and the structural headroom of such #floor area# is between five and eight feet. Any such additional #floor area# under a sloped roof shall not be used to compute the #open space ratio#

- (d) Authorizations may be granted for #buildings# to be located, #bulk# and #open space# distributed, and height and setback modified, in accordance with the provisions of this Section.
- (e) In R9, R10, C1-8, C1-9, C2-7 or C2-8 Districts, or in C1 or C2 Districts mapped within R9 or R10 Districts, #floor area# bonuses for #public plazas# or #arcades# permitted in accordance with the applicable district regulations shall apply only to a #development# or #enlargement# with 25 percent or less of the total #floor area# of the #building# in #residential use#.
- (f) Alternate window to #lot line# regulations for a #zoning lot# directly adjoining a #public park#

In R7-1 and R8 Districts within a #large scale residential development# in Community District 6 in the Borough of the Bronx, the required minimum distance between a #legally required window# and a #lot line#, as set forth in Section 23-86 (Minimum Distance Between Legally Required Windows and

Walls or Lot Lines), inclusive, shall not apply where a #legally required window# is fronting upon a #public park# with an area of at least one-half acre.

* * *

L.U. No. 485

LAMBERT HOUSES REDEVELOPMENT

BRONX - CB 6

N 160289 ZRX

Application submitted by the NYC Department of Housing Preservation and Development and Phipps Houses pursuant to Section 201 of the New York City Charter, for an amendment of the Zoning Resolution of the City of New York, to establish a Mandatory Inclusionary Housing area, Borough of the Bronx, Community District 6.

Matter in underline is new, to be added;

Matter in ~~strikeout~~ is to be deleted;

Matter within # # is defined in Section 12-10;

* * * indicates where unchanged text appears in the Zoning Resolution

* * *

APPENDIX F

Inclusionary Housing Designated Areas and Mandatory Inclusionary Housing Areas

* * *

THE BRONX

* * *



The Bronx Community District 6

In the R7-1, R7A, R7D, R7X, R8, R8A and R8X Districts within the areas shown on the following Maps 1, 2, 3, 4, ~~and~~ 5 and 6:

* * *

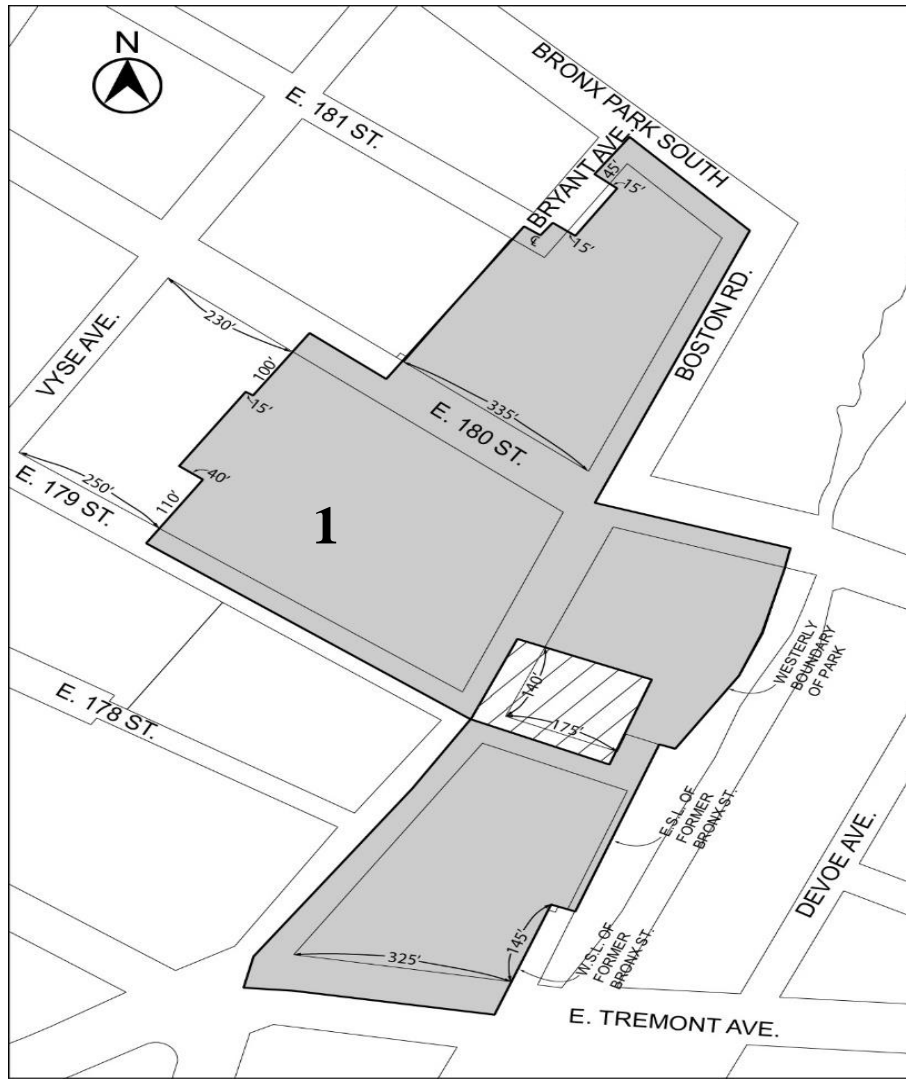
[PROPOSED MAP]



-  Mandatory Inclusionary Housing area see Section 23-154(d)(3)
- Area 1 [date of adoption] — MIH Program Option 1
-  Excluded area

Portion of Community District 6, The Bronx

* * *

L.U. No. 486

LAMBERT HOUSES REDEVELOPMENT

BRONX - CB 6

C 160290 ZSX

Application submitted by the New York City Department of Housing Preservation and Development and Phipps Houses pursuant to Sections 197-c and 201 of the New York City Charter for the grant of a special permit to Section 78-312(d) of the Zoning Resolution to modify the height and setback requirements of Section 23-632 on the periphery of a large-scale residential development, in connection with a proposed mixed-use development within a proposed large-scale residential development, on property generally bounded by Bronx Park South, Boston Road, East 180th Street, the Bronx River, East Tremont Avenue, Boston Road, East 179th Street, a line approximately 170 feet southeasterly of Boston Road, a line approximately 240 feet southwesterly of East 180th Street, Boston Road, East 179th Street, a line approximately 230 feet southeasterly of Vyse Avenue, East 180th Street, the northwesterly street line of former Bryant Avenue, East 181st Street, and Bryant Avenue (Block 3132, Lot 1, Block 3138, Lot 1, Block 3139, Lots 1, 19 & 50, and Block 3140, Lot 7), in R7-1, R7-1/C1-4, R8, and R8/C1-4 Districts.

L.U. No. 487

LAMBERT HOUSES REDEVELOPMENT

BRONX - CB 6

C 160218 MMX

Application submitted by The New York City Department of Housing Preservation and Development and Phipps Houses, pursuant to Sections 197-c and 199 of the New York City Charter, and Section 5-430 *et seq.* of the New York City Administrative Code for an amendment to the City Map involving:

- the narrowing by elimination, discontinuance and closing of a portion of East Tremont Avenue from Boston Road to East Tremont Avenue; and
- the adjustment of grades and block dimensions necessitated thereby;

including authorization for any acquisition or disposition of real property related thereto, in The Borough of The Bronx, Community District 6, in accordance with Map No. 13137 dated April 27, 2016 and signed by the Borough President.

L.U. No. 488

LAMBERT HOUSES REDEVELOPMENT

BRONX - CB 6

C 160307 ZSX

Application submitted by the New York City Department of Housing Preservation and Development and Phipps Houses pursuant to Sections 197-c and 201 of the New York City Charter for the grant of a special permit to Section 78-312(d) of the Zoning Resolution to modify the height and setback requirements of Section 23-632 on the periphery of a large-scale residential development, in connection with a proposed modification of an existing large-scale residential development, on property generally bounded by East 179th Street, Boston Road, Bryant Avenue, a line approximately 110 feet southwesterly of East Tremont Avenue, a line approximately 67 feet southeasterly of Bryant Avenue, a line approximately 80 feet southwesterly of East Tremont Avenue, a line approximately 140 feet southeasterly of Bryant Avenue, East Tremont Avenue, and a line approximately 260 feet southeasterly of Vyse Avenue, (Block 3005, Lot 65, Block 3130, Lots 20 & 100, Block 3131, Lot 20, and Block 3136, Lots 1, 20 & 101), in an R7-1 District.

L.U. No. 494

1614 WILLIAMSBRIDGE ROAD

BRONX - CB 11

C 160332 ZMX

Application submitted by Dominick Calderoni, Fred T. Santucci Jr. & Jeffrey D. Klein pursuant to Sections 197-c and 201 of the New York City Charter, for an amendment of the Zoning Map, Section No. 4b:

1. establishing within an existing R4 District a C2-2 District bounded by Pierce Avenue, a line 150 feet southwesterly of Yates Avenue, a line 75 feet southeasterly of Pierce Avenue, Williamsbridge Road, a line 50 feet southeasterly of Pierce Avenue, and a line 50 feet northeasterly of Tomlinson Avenue; and
2. establishing within an existing R4A District a C2-2 District bounded by a line 100 feet northwesterly of Pierce Avenue, Williamsbridge Road, a line 225 feet northwesterly of Pierce Avenue, a line 110 feet southwesterly of Yates Avenue, Pierce Avenue, and a line 50 feet northeasterly of Tomlinson Avenue.

L.U. NOS. 495 AND 496 ARE RELATED

L.U. No. 495

CONCOURSE VILLAGE WEST REZONING

BRONX - CB 4

C 150312 ZMX

Application submitted by the Upper Manhattan Development Corporation, pursuant to Section 197-c and 201 of the New York City Charter for the amendment of the Zoning Map, Section No. 6a:

1. changing from a C8-3 District to an R7D District property bounded by a line 100 feet northwesterly of Concourse Village West, East 156th Street, Concourse Village West, East 153rd Street, the centerline of the easterly portion of Grand Concourse, and a line 525 feet southwesterly of East 156th Street;
2. changing from a C8-3 District to an R8 District property bounded by the centerline of the easterly portion of Grand Concourse, a line 450 feet southwesterly of East 156th Street, a line 100 feet northwesterly of Concourse Village West, and a line 525 feet southwesterly of East 156th Street; and
3. establishing within the proposed R7D District a C1-4 District bounded by a line 100 feet northwesterly of Concourse Village West, East 156th Street, Concourse Village West, and a line 200 feet southwesterly of East 156th Street.

L.U. No. 496

CONCOURSE VILLAGE WEST REZONING

BRONX - CB 4

N 150313 ZRX

Application submitted by the Upper Manhattan Development Corporation pursuant to Sections 201 of the New York City Charter, for an amendment of the Zoning Resolution of the City of New York, to establish a Mandatory Inclusionary Housing area, Borough of the Bronx, Community District 4.

Matter in underline is new, to be added;

Matter in ~~strikeout~~ is to be deleted;

Matter within # # is defined in Section 12-10;

* * * indicates where unchanged text appears in the Zoning Resolution

* * *

APPENDIX F

Inclusionary Housing Designated Areas and Mandatory Inclusionary Housing Areas

* * *

The Bronx Community District 4

In portions of the #Special Grand Concourse Preservation District# and in the R7A, R7D, R8, R8A and R9D Districts within the areas shown on the following Map 1:

Map 1 – [date of adoption]

[EXISTING MAP]

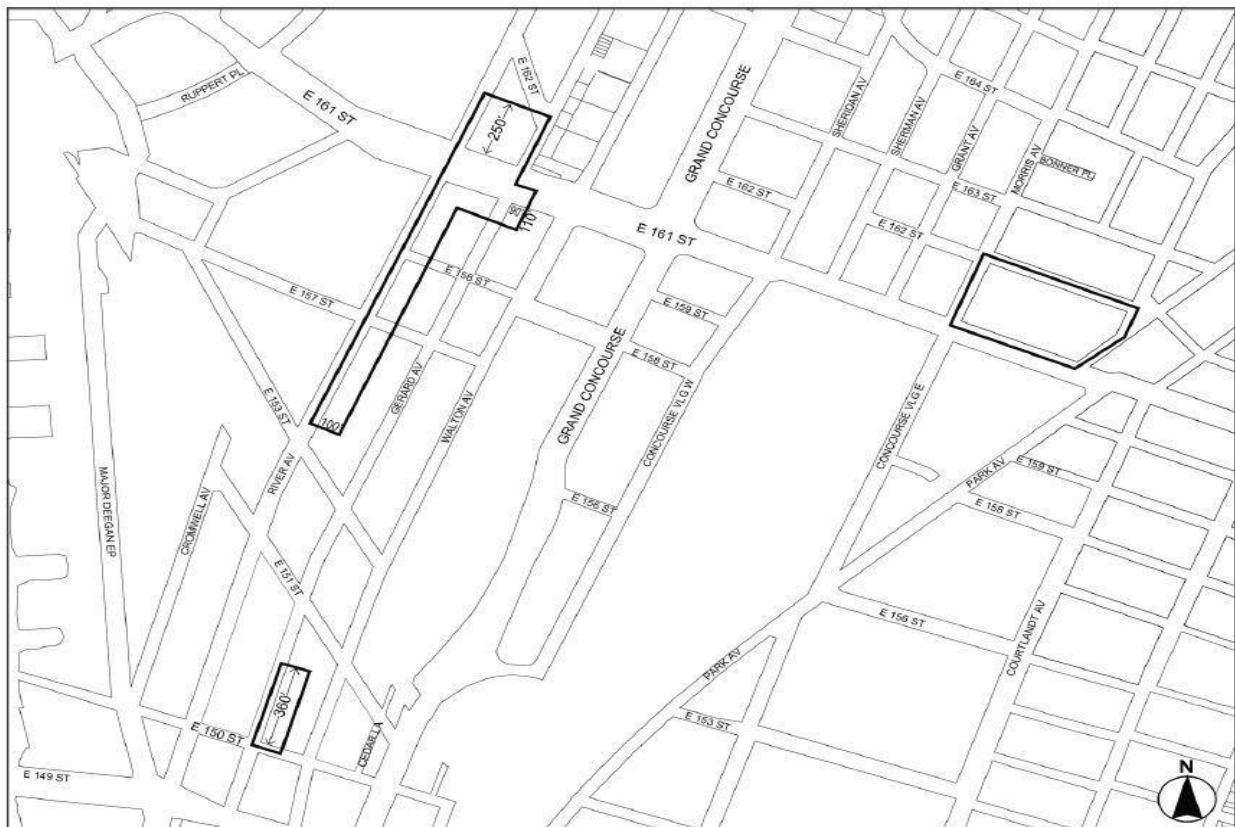

[PROPOSED MAP]

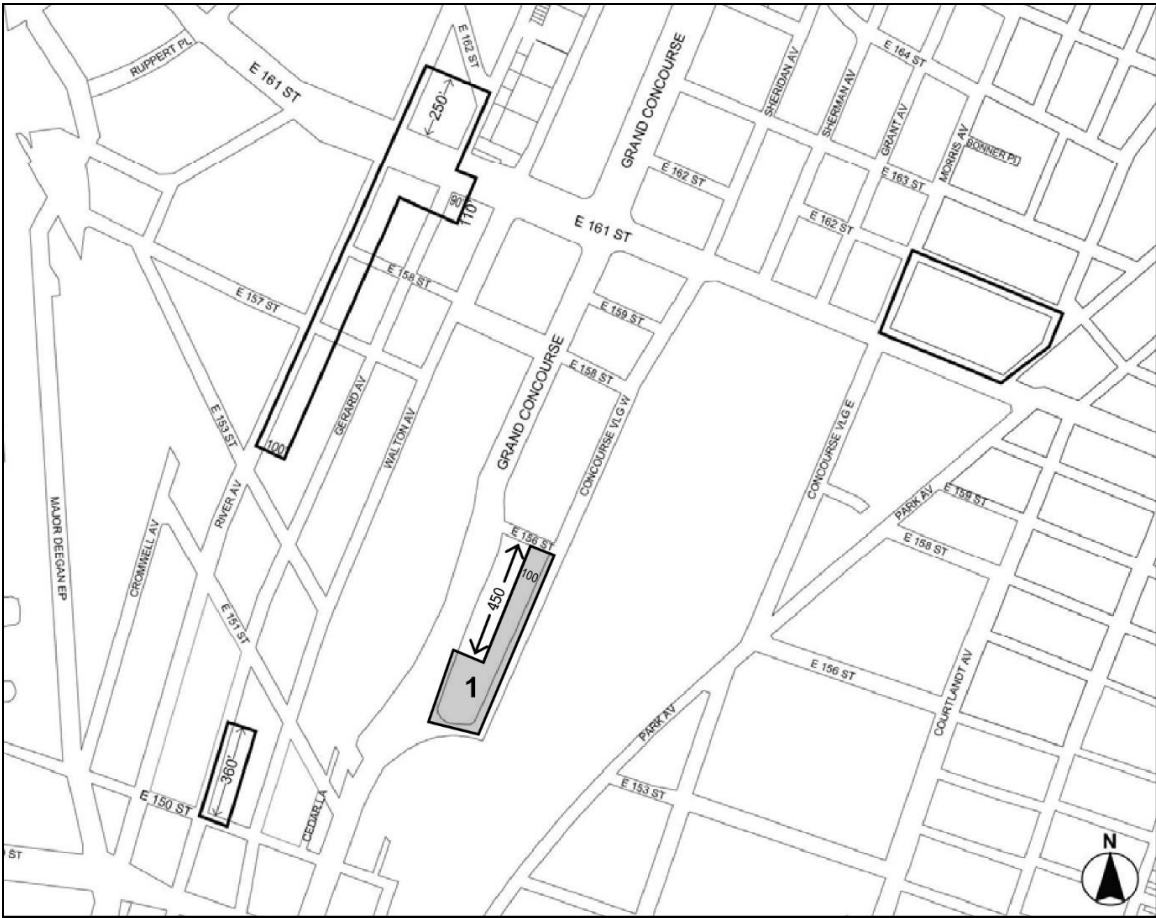

Inclusionary Housing designated area



Mandatory Inclusionary Housing area see Section 23-154(d) (3) Area 1 [date of adoption] — MIH Program Option 2

Portion of Community District 4, The Bronx

* * *

L.U. NOS. 497, 498, 499 AND 500 ARE RELATED

L.U. No. 497

1932 BRYANT AVENUE

BRONX - CB 6

C 160365 ZMX

Application submitted by Second Farms Neighborhood, HFDC pursuant to Sections 197-c and 201 of the New York City Charter for the grant of a special permit pursuant Zoning Map, Section No. 3d:

1. changing from an R7-1 District to an R8 District property bounded by Bryant Avenue, a line 80 feet southwesterly of East Tremont Avenue, a line perpendicular to the southwesterly street line of East Tremont Avenue distant 125 feet northwesterly (as measured along the street line) from the point of intersection of the southwesterly street line of East Tremont Avenue and the northwesterly street line of Boston Road, East Tremont Avenue, and Boston Road; and
2. establishing within the proposed R8 District a C2-4 District bounded by a line 100 feet northwesterly of Boston Road, a line 80 feet southwesterly of East Tremont Avenue, a line perpendicular to the southwesterly street line of East Tremont Avenue distant 125 feet northwesterly (as measured along the street line) from the point of intersection of the southwesterly street line of East Tremont Avenue and the northwesterly street line of Boston Road, East Tremont Avenue, Boston Road, and Bryant Avenue.

L.U. No. 498
1932 BRYANT AVENUE

BRONX - CB 6

N 160366 ZRX

Application submitted by the Second Farms Neighborhood HDFC, pursuant to Section 201 of the New York City Charter, for an amendment of the Zoning Resolution of the City of New York, modifying Appendix F for the purpose of establishing a Mandatory Inclusionary Housing area, Community District 6, Borough of the Bronx.

Matter in underline is new, to be added;

Matter in ~~strikeout~~ is to be deleted;

Matter within # # is defined in Section 12-10;

* * * indicates where unchanged text appears in the Zoning Resolution

* * *

APPENDIX F

Inclusionary Housing Designated Areas and Mandatory Inclusionary Housing Areas

* * *

THE BRONX

* * *

Bronx Community District 6

In the R7A, R7D, R7X, R8, R8A and R8X Districts within the areas shown on the following Maps 1, 2, 3, 4, ~~and~~ 5 and 6:

* * *

* * *

[PROPOSED MAP]

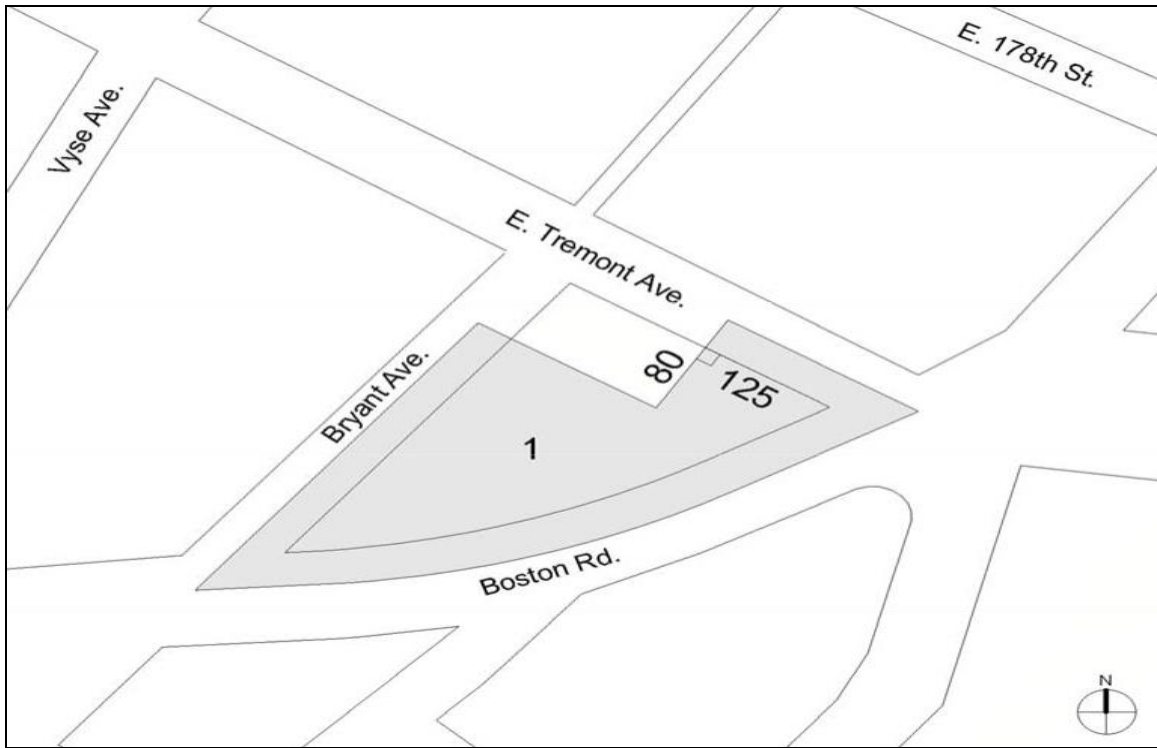

- Mandatory Inclusionary Housing area see Section 23-154(d)(3)
- Area 1 [date of adoption] – MIH Program Option 1 and Option 2

Portion of Community District 6, The Bronx

* * *

L.U. No. 499
1932 BRYANT AVENUE

BRONX - CB 6

C 160367 ZSX

Application submitted by Second Farms Neighborhood, HFDC pursuant to Sections 197-c and 201 of the New York City Charter for the grant of a special permit pursuant to Section 74-532 of the Zoning Resolution to waive the required off-street parking spaces for the existing developments on zoning lots Parcel 6 (Block 3131, Lot 20), Parcel 7 (Block 3136, Lot 1) and Parcel 8a (Block 3130, Lot 20), in connection with a proposed mixed-use development on property located at 1932 Bryant Avenue (Block 3005, Lot 65), in an R8 and R8/C2-4 Districts, within the Transit Zone, in an existing Large-Scale Residential Development generally bounded by Bryant Avenue, a line approximately 80 feet southwesterly of East Tremont Avenue, a line approximately 135 feet southeasterly of Bryant Avenue, East Tremont Avenue, a line approximately 260 feet southeasterly of Vyse Avenue, East 178th Street, a line approximately 270 feet southeasterly of Vyse Avenue, East 179th Street, and Boston Road (Block 3005 Lot 65, Block 3130 Lot 20, Block 3130 Lot 100, Block 3131 Lot 20, Block 3136 Lot 1, and Block 3136 Lot 101),) in R7-1, R8 and R8/C2-4 Districts.

L.U. No. 500
1932 BRYANT AVENUE

BRONX - CB 6

C 160368 ZSX

Application submitted by Second Farms Neighborhood, HFDC pursuant to Sections 197-c and 201 of the New York City Charter for the grant of a special permit pursuant to the following sections of the Zoning Resolution:

1. 78-312(c) to modify the rear yard requirements of Section 23-47 (Minimum Required Rear Yards), to allow minor variations in required rear yards on the periphery, and
2. 78-312(d) to modify height and setback requirements of Section 23-64 (Basic Height and Setback Requirements) to allow minor variations in the front height and setback regulations on the periphery

of a proposed mixed-use development on property located at 1932 Bryant Avenue (Block 3005, Lot 65), in R8 and R8/C2-4 Districts, within an existing Large-Scale Residential Development generally bounded by Bryant Avenue, a line approximately

80 feet southwesterly of East Tremont Avenue, a line approximately 135 feet southeasterly of Bryant Avenue, East Tremont Avenue, a line approximately 260 feet southeasterly of Vyse Avenue, East 178th Street, a line approximately 270 feet southeasterly of Vyse Avenue, East 179th Street, and Boston Road (Block 3005 Lot 65, Block 3130 Lot 20, Block 3130 Lot 100, Block 3131 Lot 20, Block 3136 Lot 1, and Block 3136 Lot 101),) in R7-1, R8 and R8/C2-4 Districts.

SUBCOMMITTEE ON LANDMARKS, PUBLIC SITING AND MARITIME USES

The Subcommittee on Landmarks, Public Siting and Maritime Uses will hold a public hearing on the following matter in the **Council Committee Room, 16th Floor, 250 Broadway**, New York City, New York 10007, commencing at **11:00 A.M., Wednesday, October 19, 2016:**

L.U. No. 493

WILLIAMSBURG TRUST COMPANY

BROOKLYN - CB 1

20175059 HKK (N 170058 HKK)

Designation by the Landmarks Preservation Commission [DL-489/LP-0163] pursuant to Section 3020 of the New York City Charter of the landmark designation of the Williamsburg Trust Company Building, located at 177-185 South 5th Street (Block 2446, Lot 63), as an historic landmark.

SUBCOMMITTEE ON PLANNING, DISPOSITIONS AND CONCESSIONS

The Subcommittee on Planning, Dispositions and Concessions will hold a public hearing on the following matter in the **Council Committee Room, 16th Floor, 250 Broadway**, New York City, New York 10007, commencing at **1:00 P.M., Wednesday, October 19, 2016:**

L.U. No. 428

BLAKE HENDRIX

BROOKLYN - CB 5

20175024 HAK

Application submitted by the New York City Department of Housing Preservation and Development pursuant to Article XI of the Private Housing Finance Law and Article 16 of the General Municipal Law for approval of a real property tax exemption, an urban development action area project, waiver of the area designation requirement and Sections 197-c and 197-d of the New York City Charter for properties located at Block 4050, Lot 25, Block 4067, Lot 8, Block 4058, Lot 18, Block 4081, Lot 23, Block 4065, Lot 22, Block 3767, Lots 10-13, Block 4060, Lot 16, and Block 4062, Lot 30, Community Board 5, Council District 42, Borough of Brooklyn.



LAND USE COMMITTEE

The Land Use Committee will hold a meeting in the **Council Committee Room, 14th Floor, 250 Broadway**, New York City, New York 10007, commencing at **11:00 A.M. on Thursday, October 20, 2016**, to consider all items reported out of the Subcommittees at the meetings held on Wednesday, October 19, 2016, and conduct such other business as may be necessary.