



COUNCIL OF THE CITY OF NEW YORK

**CALENDAR
OF THE**

LAND USE COMMITTEE

FOR THE WEEK OF SEPTEMBER 19, 2016 - SEPTEMBER 23, 2016

DAVID G. GREENFIELD, *Chair*, Land Use Committee

DONOVAN J. RICHARDS, *Chair*, Subcommittee on Zoning and Franchises

PETER KOO, *Chair*, Subcommittee on Landmarks, Public Siting
and Maritime Uses

INEZ DICKENS, *Chair*, Subcommittee on Planning, Dispositions
and Concessions

<http://legistar.council.nyc.gov/Calendar.aspx>

SUBCOMMITTEE ON ZONING AND FRANCHISES

The Subcommittee on Zoning and Franchises will hold a public hearing on the following matters in the **Council Chambers, City Hall**, New York City, New York 10007, commencing at **9:30 A.M., Tuesday, September 20, 2016:**

L.U. No. 458

ALTUS CAFÉ

MANHATTAN - CB 12

20165640 TCM

Application pursuant to Section 20-226 of the Administrative Code of the City of New York, concerning the petition of Carnival Latin Bistro Corp., d/b/a Altus Café, for a new revocable consent to establish, maintain and operate an unenclosed sidewalk café located at 4325 Broadway.

L.U. No. 438

ADORAMA

MANHATTAN - CB 5

C 160082 ZSM

Application submitted by 42 West 18th Realty Corp. pursuant to Section 197-c and 201 of the New York City Charter, for the grant of a special permit pursuant to Section 74-711 (Landmark Preservation In all Districts) of the Zoning Resolution to modify height and setback requirements, rear yard requirements, and minimum distance between buildings requirements, to facilitate a mixed-use development on property located at 38-42 West 18th Street (Block 819, Lots 14, 15 and 66), in a C6-4A District, within the Ladies Mile Historic District.

PRECONSIDERED L.U. NOS. , , AND ARE RELATED

PRECONSIDERED L.U.

BARNETT AVENUE REZONING

QUEENS - CB 2

C 160103 ZMQ

Application submitted by Sunnyside-Barnett Associates LLC pursuant to Sections 197-c and 201 of the New York City Charter for an amendment of the Zoning Map, Section Nos. 9b and 9d as follows:

1. changing from an M1-1 District to an M1-1/R6 district property bounded by the southerly boundary line of the Long Island Rail Road Right-of-Way (Main Line), the northerly centerline prolongation of 52nd Street, Barnett Avenue, and the northerly prolongation of the westerly streetline of 50th Street; and
2. establishing a Special Mixed Use District (MX-17) bounded by the southerly boundary line of the Long Island Rail Road Right-of-Way (Main Line), the northerly centerline prolongation of 52nd Street, Barnett Avenue, and the northerly prolongation of the westerly streetline of 50th Street.

PRECONSIDERED L.U.

BARNETT AVENUE REZONING

QUEENS - CB 2

N 160101 ZRQ

Application submitted by Sunnyside-Barnett Associates LLC pursuant to Section 201 of the New York City Charter, for an amendment of the Zoning Resolution of the City of New York, modifying Appendix F for the purpose of establishing a Mandatory Inclusionary Housing area.

Matter in underline is new, to be added;

Matter in ~~strikeout~~ is to be deleted;

Matter within # # is defined in Section 12-10;

* * * indicates where unchanged text appears in the Zoning Resolution

* * *

APPENDIX F

Inclusionary Housing Designated Areas and Mandatory Inclusionary Housing Areas

* * *

Queens

* * *

Queens Community District 2

In the R6, R7A and R7X Districts within the areas shown on the following Maps 1, ~~and 2~~ and 4:

* * *

Map 4 – (date of adoption)

[Proposed Map]

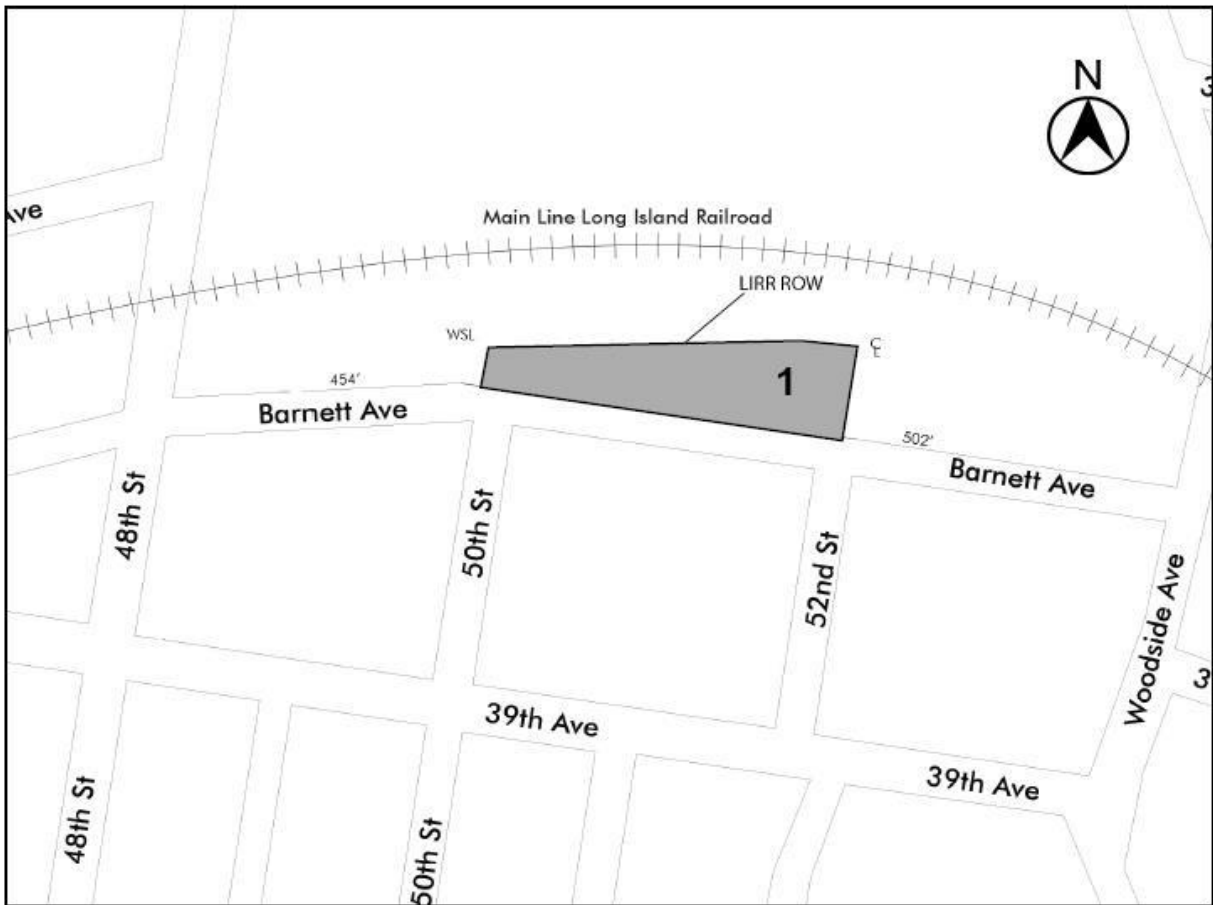

 Mandatory Inclusionary Housing area see Section 23-154(d)(3)

Area 1 (date of adoption) – MIH Program Option 2

Portion of Community District 2, Queens

* * *

**PRECONSIDERED L.U.
BARNETT AVENUE REZONING**

QUEENS - CB 2

N 160102 ZRQ

Application submitted by Sunnyside-Barnett Associates LLC pursuant to Section 201 of the New York City Charter, for an amendment of the Zoning Resolution of the City of New York, to establish that R6 districts in Mandatory Inclusionary Housing areas are allowed a maximum FAR of 3.6, to establish Mixed-Use District MX-17 (M1-1/R6) and to modify height and setback regulations in MX-17 (M1-1/R6), Borough of Queens, Community District 2.

Matter in underline is new, to be added;

Matter in ~~strikeout~~ is to be deleted;

Matter within # # is defined in Section 12-10;

* * * indicates where unchanged text appears in the Zoning Resolution

* * *

**Article II
RESIDENCE DISTRICT REGULATIONS**

**Chapter 3
Bulk Regulations for Residential Buildings in Residence Districts**

* * *

**23-10
OPEN SPACE AND FLOOR AREA REGULATIONS
R1 R2 R3 R4 R5 R6 R7 R8 R9 R10**

* * *

**23-15
Open Space and Floor Area Regulations in R6 through R10 Districts
R6 R7 R8 R9 R10**

* * *

23-154

Inclusionary Housing

For #developments# or #enlargements# providing #affordable housing# pursuant to the Inclusionary Housing Program, as set forth in Section 23-90, inclusive, the maximum #floor area ratio# permitted in R10 Districts outside of #Inclusionary Housing designated areas# shall be as set forth in paragraph (a) of this Section, and the maximum #floor area ratio# in the #Inclusionary Housing designated areas# existing on [date of adoption] shall be as set forth in paragraph (b) of this Section. Special provisions for specified #Inclusionary Housing designated areas# are set forth in paragraph (c) of this Section. The maximum #lot coverage# shall be as set forth in Section 23-153 (For Quality Housing buildings) for the applicable zoning district. For the purpose of this Section, defined terms include those set forth in Sections 12-10 and 23-911.

* * *

(b) #Inclusionary Housing designated areas#

The #residential floor area# of a #zoning lot# may not exceed the base #floor area ratio# set forth in the Table in this paragraph (b), except that such #floor area# may be increased on a #compensated zoning lot# by 1.25 square feet for each square foot of #low income floor area# provided, up to the maximum #floor area ratio# specified in the Table, as applicable. However, the amount of #low income floor area# required to receive such #floor area compensation# need not exceed 20 percent of the total #floor area#, exclusive of ground floor non-#residential floor area#, or any #floor area# increase for the provision of a #FRESH food store#, on the #compensated zoning lot#.

Maximum #Residential Floor Area Ratio#

District	Base #floor area ratio#	Maximum #floor area ratio#
R6B	2.00	2.20
R6 ¹	2.20	2.42
R6 ^{2,3} R6A R7-2 ¹	2.70	3.60
R7A R7-2 ²	3.45	4.60
R7-3	3.75	5.0
R7D	4.20	5.60
R7X	3.75	5.00
R8	5.40	7.20
R9	6.00	8.00
R9A	6.50	8.50
R9D	7.5	10.0
R9X	7.3	9.70
R10	9.00	12.00

¹for #zoning lots#, or portions thereof, beyond 100 feet of a #wide street#

²for #zoning lots#, or portions thereof, within 100 feet of a #wide street#

³for #zoning lots# in #Mandatory Inclusionary Housing areas#

* * *

**Article XII
SPECIAL PURPOSE DISTRICTS**

**Chapter 3
Special Mixed Use District**

* * *

**123-60
SPECIAL BULK REGULATIONS**

* * *

**123-63
Maximum Floor Area Ratio and Lot Coverage Requirements for Zoning Lots
Containing Only Residential Buildings in R6, R7, R8 and R9 Districts**

Where the designated #Residence District# is an R6, R7, R8 or R9 District, the minimum required #open space ratio# and maximum #floor area ratio# provisions of Section 23-151 (Basic regulations for R6 through R9 Districts), shall not apply. In lieu thereof, all #residential buildings#, regardless of whether they are required to be #developed# or #enlarged# pursuant to the Quality Housing Program, shall comply with the maximum #floor area ratio# and #lot coverage# requirements set forth for the designated district in Section 23-153 (For Quality Housing buildings), or Section 23-155 (Affordable independent residences for seniors), as applicable.

* * *

However, in #Inclusionary Housing designated areas#, as listed in the table in this Section, the maximum permitted #floor area ratio# shall be as set forth in Section 23-154 (Inclusionary Housing). The locations of such districts are specified in APPENDIX F of this Resolution.

	Designated #Residence
<u>#Special Mixed Use District#</u>	<u>District#</u>

MX 2 - Community District 2, Brooklyn	R7A R8A
MX 8 - Community District 1, Brooklyn	R6 R6A R6B R7A
MX 11 - Community District 6, Brooklyn	R7-2
MX 13 – Community District 1, The Bronx	R6A R7A R7X R8A
MX 14 - Community District 6, The Bronx	R7A R7X
<u>MX 17 - Community District 2, Queens</u>	<u>R6</u>

* * *

123-66
Height and Setback Regulations

* * *

123-662
All buildings in Special Mixed Use Districts with R6, R7, R8, R9 and R10
District designations

In #Special Mixed Use Districts# where the designated #Residence District# is an R6, R7, R8, R9 or R10 District, the height and setback regulations of Sections 23-60 and 43-40 shall not apply. In lieu thereof, all #buildings or other structures# shall comply with the height and setback regulations of this Section.

(a) Medium and high density non-contextual districts

(1) In #Special Mixed Use# Districts# where the designated

#Residence District# is an R6, R7, R8, R9 or R10 District without a letter suffix, the height of a #building or other structure#, or portion thereof, located within 10 feet of a #wide street# or 15 feet of a #narrow street#, may not exceed the maximum base height specified in Table A of this Section, except for dormers permitted in accordance with paragraph (c) of this Section. Beyond 10 feet of a #wide street# and 15 feet of a #narrow street#, the height of a #building or other structure# shall not exceed the maximum #building# height specified in Table A. However, a #building or other structure# may exceed such maximum #building# height by four #stories# or 40 feet, whichever is less, provided that the gross area of each #story# located above the maximum #building# height does not exceed 80 percent of the gross area of that #story# directly below it.

Table A
 HEIGHT AND SETBACK FOR ALL BUILDINGS
 IN MEDIUM AND HIGH DENSITY
 NON-CONTEXTUAL DISTRICTS
 (in feet)

District	Maximum Base Height	Maximum #Building# Height
R6	60	110
R7-1 R7-2	60	135
R7-3	85	185
R8	85	210
R9	85	225
R9-1	85	280
R10	110	350

(2) In #Special Mixed Use District# 15 in the Borough of Manhattan, where the designated #Residence District# is an R7-2 District, the height and setback regulations of paragraph (a)(1) of this Section shall not apply. In lieu thereof, the height and setback regulations of this paragraph, (a)(2), shall apply.

(i) A #building or other structure#, or portion thereof, located within ten feet of a #wide street# or 15 feet of a #narrow street#, shall rise to a minimum height of 60₁₀feet, and may rise to a maximum height of

85 feet, except for dormers permitted in accordance with paragraph (c) of this Section.

- (ii) At least 70 percent of the #aggregate width of street walls# shall be located on the #street line# and shall extend to the minimum base height of 60 feet or the height of the #building#, whichever is less. The remaining 30 percent of the #aggregate width of street walls# shall be located within eight feet of the #street line#.
- (iii) Existing #buildings# may be vertically #enlarged# by up to one #story# or 15 feet without regard to the #street wall# location provisions of this paragraph, (a)(2). Beyond ten feet of a #wide street# and 15 feet of a #narrow street#, the height of a #building or other structure# shall not exceed a maximum #building# height of 135 feet. However, a #building or other structure# may exceed a height of 135 feet by four #stories# or 40 feet, whichever is less, provided that the gross area of each #story# located above 135 feet does not exceed 80 percent of the gross area of that #story# directly below it.

(3) In #Special Mixed Use District# 17 in the Borough of Queens, where the designated #Residence District# is an R6 District, the height and setback regulations of paragraph (a)(1) of this Section shall be modified such that a #building or other structure#, or portion thereof, located within ten feet of a #wide street# or 15 feet of a #narrow street#, may rise to a maximum base height of 85 feet provided that such #building or other structure# contains #affordable housing# pursuant to Section 23-90 (INCLUSIONARY HOUSING).

* * *

123-90

SPECIAL MIXED USE DISTRICTS SPECIFIED

The #Special Mixed Use District# is mapped in the following areas:

* * *

#Special Mixed Use District# - 17: ([date of adoption])
Sunnyside, Queens

The #Special Mixed Use District# - 17 is established in Sunnyside in Queens
as indicated on the #zoning maps#.

* * *



SUBCOMMITTEE ON LANDMARKS, PUBLIC SITING AND MARITIME USES

The Subcommittee on Landmarks, Public Siting and Maritime Uses will hold a

public hearing on the following matters in the **Council Committee Room, 16th Floor, 250 Broadway**, New York City, New York 10007, commencing at **11:00 A.M., Tuesday, September 20, 2016:**

L.U. No. 467

MITCHELL-LINDEN LIBRARY SITE

QUEENS - CB 7

C 160247 PQQ

Application submitted by the Queens Public Library and the New York City Department of Citywide Administrative Services, pursuant to Section 197-c of the New York City Charter, for the acquisition of property located at 31-32 Union Street (Block 4414, Lots 1333-1339) for continued use as a library.

L.U. No. 468

ROSEDALE LIBRARY SITE

QUEENS - CB 13

C 160248 PQQ

Application submitted by the Queens Public Library and the New York City Department of Citywide Administrative Services, pursuant to Section 197-c of the New York City Charter, for the acquisition of property located at 144-20 243rd Street (Block 13549, Lot 7) for continued use as a library.



SUBCOMMITTEE ON PLANNING, DISPOSITIONS AND CONCESSIONS

The Subcommittee on Planning, Dispositions and Concessions will hold a public hearing on the following matters in the **Council Committee Room, 16th Floor, 250 Broadway**, New York City, New York 10007, commencing at **1:00 P.M., Tuesday, September 20, 2016:**

L.U. No. 427

HOPE EAST OF FIFTH RESYNDICATION

MANHATTAN - CB 11

20175023 HAM

Application submitted by the New York City Department of Housing Preservation and Development pursuant to Article 16 of the General Municipal Law for approval of an urban development action area project and waiver of the area designation requirement and Sections 197-c and 197-d of the New York City Charter for property located at 212 East 117th Street (Block 1666, Lot 41), in Community Board 11, Council District 8, Borough of Manhattan.

L.U. No. 428

BLAKE HENDRIX

BROOKLYN - CB 5

20175024 HAK

Application submitted by the New York City Department of Housing Preservation and Development pursuant to Article XI of the Private Housing Finance Law and Article 16 of the General Municipal Law for approval of a real property tax exemption, an urban development action area project, waiver of the area designation requirement and Sections 197-c and 197-d of the New York City Charter for properties located at Block 4050, Lot 25, Block 4067, Lot 8, Block 4058, Lot 18, Block 4081, Lot 23, Block 4065, Lot 22, Block 3767, Lots 10-13, Block 4060, Lot 16, and Block 4062, Lot 30, Community Board 5, Council District 42, Borough of Brooklyn.

L.U. No. 453
SOUTHEASTERN QUEENS VACANT HOMES PROJECT
CLUSTER 4, CD 27

QUEENS - CBs 12 and 13

20175039 HAQ

Application submitted by the New York City Department of Housing Preservation and Development pursuant to Section 696 of Article 16 of the General Municipal Law for approval of a real property tax exemption, an urban development action area project, waiver of the area designation requirement and Sections 197-c and 197-d of the New York City Charter for properties located at 223-19 111th Avenue (Block 11206, Lot 67), 114-26 208th Street (Block 11026, Lot 379), 197-18 116th Avenue (Block 11069, Lot 198), 190-17 115th Drive (Block 11033, Lot 69), 117-27 204th Street (Block 12634, Lot 24), 198-14 119th Avenue (Block 12654, Lot 7), 190-01 118th Road (Block 12605, Lot 39), 186-20 Foch Boulevard (Block 12438, Lot 142), 177-48 Baisley Boulevard (Block 12462, Lot 12), 177-19 120th Avenue (Block 12469, Lot 137), 171-48 119th Road (Block 12375, Lot 85), 168-32 119th Avenue (Block 12370, Lot 16), and 168-31 118th Road (Block 12368, Lot 53), in Community Boards 12 and 13, Council District 27, Borough of Queens.

L.U. No. 454
SOUTHEASTERN QUEENS VACANT HOMES PROJECT
CLUSTER 1, CD 21

QUEENS - CB 3

20175036 HAQ

Application submitted by the New York City Department of Housing Preservation and Development pursuant to Section 696 of Article 16 of the General Municipal Law for approval of a real property tax exemption, an urban development action area project, and waiver of the area designation requirement and Sections 197-c and 197-d of the New York City Charter for property located at 32-10 102nd Street (Block 01696, Lot 9), in Community Board 3, Council District 21, Borough of Queens.

L.U. No. 455
SOUTHEASTERN QUEENS VACANT HOMES PROJECT
CLUSTER 2, CD 23

QUEENS - CB 13

20175037 HAQ

Application submitted by the New York City Department of Housing Preservation and Development pursuant to Section 696 of Article 16 of the General Municipal Law for approval of a real property tax exemption, an urban development action area project, and waiver of the area designation requirement and Sections 197-c and 197-d of the New York City Charter for property located at 89-55 208th Street (Block 10573, Lot 43), in Community Board 13, Council District 23, Borough of Queens.

L.U. No. 456
SOUTHEASTERN QUEENS VACANT HOMES PROJECT
CLUSTER 3, CD 24

QUEENS - CB 8

20175038 HAQ

Application submitted by the New York City Department of Housing Preservation and Development pursuant to Section 696 of Article 16 of the General Municipal Law for approval of a real property tax exemption, an urban development action area project, and waiver of the area designation requirement and Sections 197-c and 197-d of the New York City Charter for property located at 80-44 162nd Street (Block 06856, Lot 59), in Community Board 8, Council District 24, Borough of Queens.

L.U. No. 457
SOUTHEASTERN QUEENS VACANT HOMES PROJECT
CLUSTER 5, CD 31

QUEENS - CBs 12 and 13

20175040 HAQ

Application submitted by the New York City Department of Housing Preservation and Development pursuant to Section 696 of Article 16 of the General Municipal Law for approval of a real property tax exemption, an urban development action area project, and waiver of the area designation requirement and Sections 197-c and 197-d of the New York City Charter for properties located at 144-41 158th Street (Block 15013, Lot 4), 171-15 144th Avenue (Block 12594, Lot 16), and 222-33 143rd Road (Block 13086, Lot 57), in Community Boards 12 and 13, Council District 31, Borough of Queens.

PRECONSIDERED L.U.

LA CENTRAL

BRONX - CB 1

20175071 HAX

Application submitted by the New York City Department of Housing Preservation and Development for the approval a of real property tax exemption pursuant to Section 577 of the Private Housing Finance Law for properties located at 430 Westchester Avenue (Block 2294, Lot 32), 599 Brook Avenue (Block 2361, Lot 1), 625 Brook Avenue (Block 2361, Lot 26), 626 Bergen Avenue (Block 2361, Lot 50), and 503 East 153rd Street (Block 2363, Lot 1), Borough of the Bronx, Community District 1, Council District 17.



LAND USE COMMITTEE

The Land Use Committee will hold a meeting in the **Committee Room, City Hall**, New York City, New York 10007, commencing at **11:00 A.M. on Thursday, September 22, 2016**, to consider all items reported out of the Subcommittees at the meetings held on Tuesday, September 20, 2016, and conduct such other business as may be necessary.