

CITY COUNCIL  
LAND USE DIVISION

2015 OCT 17 P 4:40



CITY PLANNING COMMISSION  
CITY OF NEW YORK

OFFICE OF THE CHAIRMAN

NYC COUNCIL

2015 OCT 17 P 4:23

SPEAKER'S OFFICE

October 17, 2016

City Council  
City Hall  
New York, NY 10007

Re: East 147<sup>th</sup> Street Rezoning  
Application No. N 160250 ZRX (LU 475)  
Related Applications No. C 160251 ZMX (LU 476)  
Borough of The Bronx

Honorable Members of the Council:

The City Planning Commission (the "Commission") has received the attached correspondence, dated October 7, 2016, from the City Council regarding the proposed modification to the above-referenced application submitted by MLK Plaza LLC for a text amendment mapping Mandatory Inclusionary Housing within Community Board 1 in the Bronx.

In accordance with Section 197-d(d) of the New York City Charter, the Commission, on October 17, 2016, has determined that the City Council's proposed modification raises no land use or environmental issues requiring further review.

Sincerely,

A handwritten signature in blue ink, appearing to read "Carl Weisbrod".

Carl Weisbrod

c: C. Samol  
A. Laremont

D. DeCerbo  
J. Harris

M. Parkinson  
J. Mangin

Carl Weisbrod, Chairman  
City Planning Commission  
22 Reade Street - 2N, New York, N.Y. 10007-1216  
(212) 720-3200 FAX (212) 720-3219  
[www.nyc.gov/planning](http://www.nyc.gov/planning)



THE COUNCIL  
THE CITY OF NEW YORK  
LAND USE DIVISION  
250 BROADWAY - ROOM 1602  
NEW YORK NEW YORK 10007

RAJU MANN  
DIRECTOR

TEL.: 212-788-7335  
[RMann@council.nyc.gov](mailto:RMann@council.nyc.gov)

October 7, 2016

**BY HAND**

Honorable Carl Weisbrod, Chairman  
City Planning Commission  
120 Broadway, 31<sup>st</sup> Floor  
New York, NY 10271

**RE: East 147<sup>th</sup> Street Rezoning  
Application No. N 160250 ZRX (LU 475)  
Related Application No. C 160251 ZMX (LU 476)**

Dear Chairman Weisbrod:

Today, October 6, 2016, the Land Use Committee of the City Council, by a vote of 19-0-0 for N 160250 ZRX, recommended modification of the City Planning Commission's decision in the above-referenced matter.

Pursuant to Section 197-d(d) of the City Charter and Section 11.70 of the Rules of the Council, I hereby file the proposed modification with the Commission:

Matter in double ~~strikeout~~ is deleted by the City Council;  
Matter in double-underline is added by the City Council

\* \* \*

**APPENDIX F**

**Inclusionary Housing Designated Areas and Mandatory Inclusionary Housing Areas**

\* \* \*

**THE BRONX**

**The Bronx Community District 1**

Honorable Carl Weisbrod  
N 160250 ZRX (LU 475), C 160251 ZMX (476)  
October 7, 2016  
Page 2 of 3

In the #Special Harlem River Waterfront District# (see Section 87-20) and in the R7A, R7X  
and R8A Districts within the areas shown on the following Maps 1 and 2:

\* \* \*

Map 2 – [date of adoption]

[PROPOSED MAP]

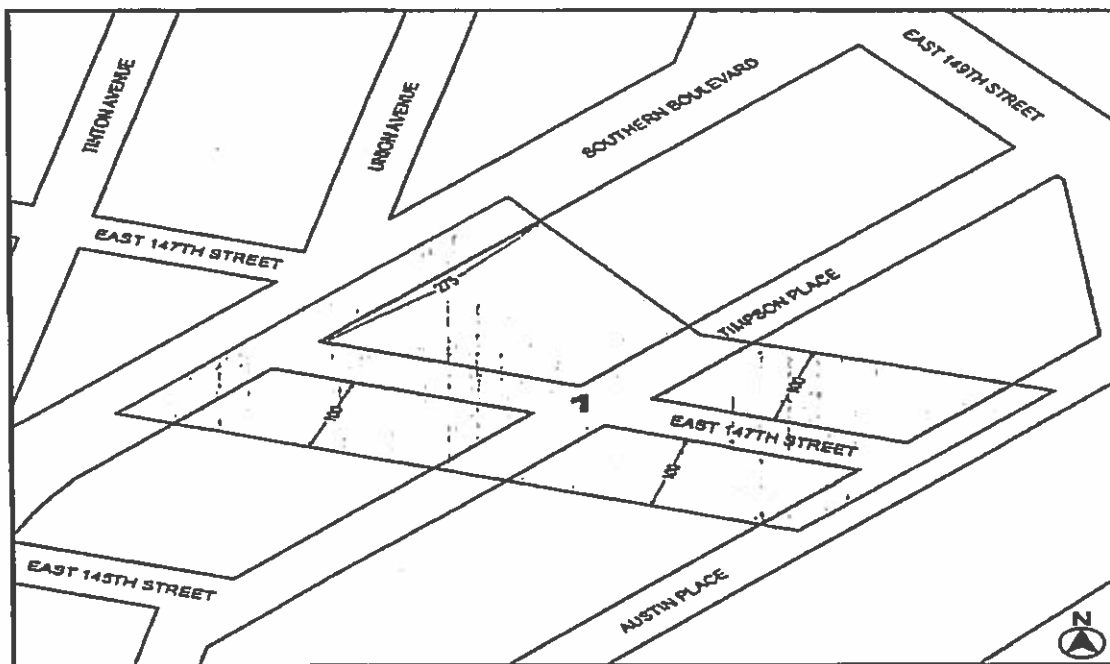

Mandatory Inclusionary Housing area see Section 23-154(d)(3)  
Area 1 [date of adoption] — MIH Program Option 1 and ~~Option 2-Deep Affordability~~  
Option

Portion of Community District 1, The Bronx

\* \* \*

Honorable Carl Weisbrod  
N 160250 ZRX (LU 475), C 160251 ZMX (476)  
October 7, 2016  
Page 3 of 3

Please feel free to contact me at (212) 482-5185 if you or your staff has any questions in this regard.

Sincerely,



.....  
Julie Lubin, Esq.  
General Counsel

JL:mg

RECEIVED BY: \_\_\_\_\_

DATE: \_\_\_\_\_

TIME: \_\_\_\_\_

- c: Members, City Planning Commission
- Raju Mann, Director, Land Use Division
- Amy Levitan, Deputy Director, Land Use Division
- Anita Laremont, Esq., DCP
- Danielle J. DeCerbo, DCP
- File